

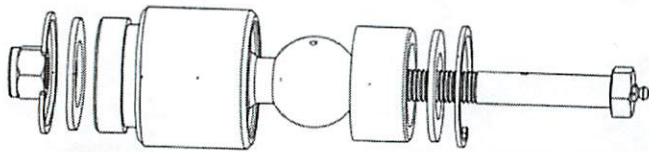

[www.DaystarWeb.com](http://www.DaystarWeb.com)  
 Tech Support: [Tech@DaystarWeb.com](mailto:Tech@DaystarWeb.com)  
 Phone: 623.907.0081 Fax: 623.907.0088  
 841 South 71<sup>st</sup> Avenue, Phoenix, AZ 85043

- KU70087 2.0" Poly Flex Joint Upgrade Kit
- KU70088 2.5" Poly Flex Joint Upgrade Kit
- KU70089 2.5" Poly Joint Replacement Kit
- KU70090 2.0" Poly Joint Replacement Kit

NOTE: Figures illustrate how all kits assemble. Remember to lubricate moving parts before assembly. Daystar Products Inc. recommends using kit [KU70091, 2.0 and 2.5" Poly-Flex Installation tool] to compress the Poly Flex joints together, and the KU11005 Poly grease gun to lubricate all joints.



KU70087 2.0" 2.0" Poly Flex Joint Upgrade kit

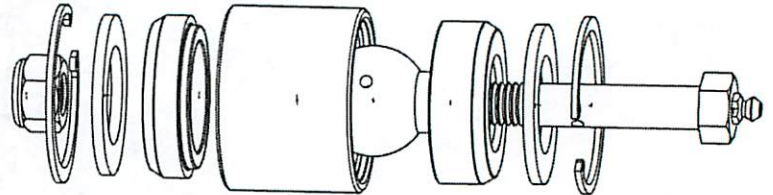

KU70088 2.5" Poly Flex Joint Upgrade kit

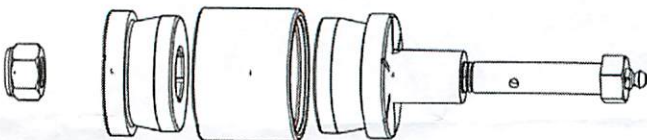

KU70090 2.0" Poly Joint replacement kit

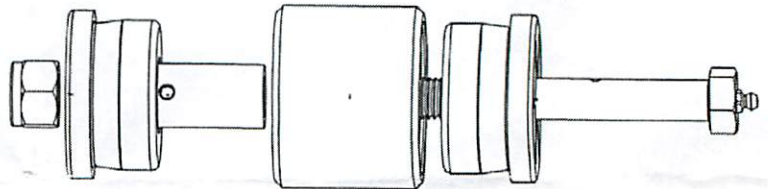

KU70089 2.5" Poly Joint replacement kit

**Warranty:**

Four Real Steel Products carry a limited warranty: This Limited Warranty does not include normal wear and tear and is void if product shows any evidence of misuse, abuse, accident/collision, road hazard, improper installation and or maintenance or modification. This warranty does not cover cost of removal, installation, shipping or other incidental charges. This warranty is limited to the repair and/or replacement of the Four Real Steel Product only at the discretion of Four Real Steel Products, Inc. ALL WARRANTY ISSUES MUST BE ACCOMPANIED BY A SALES RECEIPT WITH TRANSPORTATION OR SHIPPING CHARGES PREPAID. This warranty extends only to the original purchaser of the Four Real Steel Products.

**WARNING**

This vehicle has been modified to enhance its performance. The steering, braking and handling of this vehicle will differ from standard passenger cars and trucks. This vehicle handles differently from an ordinary vehicle in driving conditions which may occur on streets, highways and off road.

Avoid unnecessary abrupt maneuvers, sudden stops, sharp turns and other driving conditions that could cause loss of control, possibly leading to a roll over or other accident that could result in serious injury or death to driver and passengers.

If larger tires are installed the speedometer will read lower than the vehicles actual speed.  
**DRIVE WITH CARE, REDUCE SPEED**

**AND WEAR SEAT BELTS AT ALL TIMES.**

This kit should be installed by a professional mechanic.

Instruction Sheet – P10855-00

